

FLX Stix NDFree 240V Dimmable

LED Linear Light FLX Stix NDFree Dimmable Warm White 3000K 240V 570mm
10W 720lm

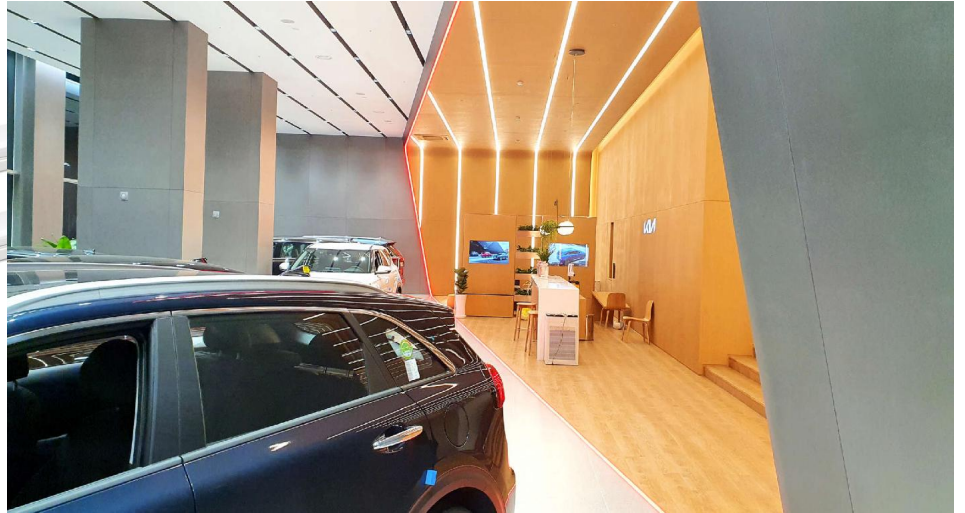

NDF10 240V30K

10W 720lm

Quicklink: Q6146

General

Colour	White
Construction	Plastic
Dimmable	Yes
IP Rating	IP20

Dimensions

Depth	16.8mm
Length	569.5mm
Width	18mm

Electrical

Maximum Wattage	10W
Voltage	240V

Light Characteristics

Colour Rendering Index	90
Colour Temperature	3000K Warm White
Lumens	720lm
Lumens Per Metre	1264lm/m
Lumens Per Watt	72lm/W
Watts Per Metre	17.6W/m

The FLX Stix NDFree is a slender fixture that fits almost anywhere and is perfect for showcases and retail cabinet displays. It's a little light that packs a big punch and is easy to install with a quick connection system. The NDFree can be fixed by either magnets or clips both provided with the fitting. It requires no driver, making it simple to install. There are no dark spots even at the linking points. The light is professional quality with no difference in light colour throughout the range. Works with Trailing Edge Dimmers, not Leading Edge Dimmers.

Max. connection - 400W in one row (single power feed).

Key Features

- Easy and quick installation, Long connection
- LED driver is not required (AC Direct Powered)
- Innovative Slim design
- Safe connection with locking system
- No dark spot at the linkage point for seamless effect
- Line voltage dimming

Product Video

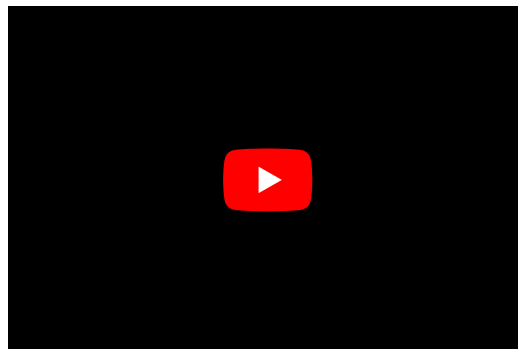

FLX Stix NDFree 240V Dimmable

LED Linear Light FLX Stix NDFree Dimmable Warm White 3000K 240V 570mm
10W 720 lm

Model Number	Voltage Input(V)	Lamp Power(W)	Lumens(lm) (CRI90)	A inches (mm)	B inches (mm)	C inches (mm)	D inches (mm)	E inches (mm)	F inches (mm)	G inches (mm)
NDF3-Color)K-230V-09	AC220-240	2.5	212	5.8 (147)	6.1 (156)	7 (178.3)	0.75 (19)	0.71 (18)	0.71 (18)	0.66 (16.8)
NDF5-Color)K-230V-09	AC220-240	5.34	340	11.1 (282.3)	11.5 (291.5)	12.4 (314)	0.75 (19)	0.71 (18)	0.71 (18)	0.66 (16.8)
NDF10-Color)K-230V-09	AC220-240	10.9	720	22 (560.9)	22.4 (569.9)	23.3 (592)	0.75 (19)	0.71 (18)	0.71 (18)	0.66 (16.8)
NDF15-Color)K-230V-09	AC220-240	16.0	1,000	33 (839)	33.4 (849)	34.3 (870.9)	0.75 (19)	0.71 (18)	0.71 (18)	0.66 (16.8)
NDF20-Color)K-230V-09	AC220-240	21.3	1,440	43.4 (1,117)	43.3 (1,126)	45.2 (1,148.5)	0.75 (19)	0.71 (18)	0.71 (18)	0.66 (16.8)

