

Emergency Exit Lights

LED Emergency Exit Blade
2.5W Surfaced Wall/Ceiling

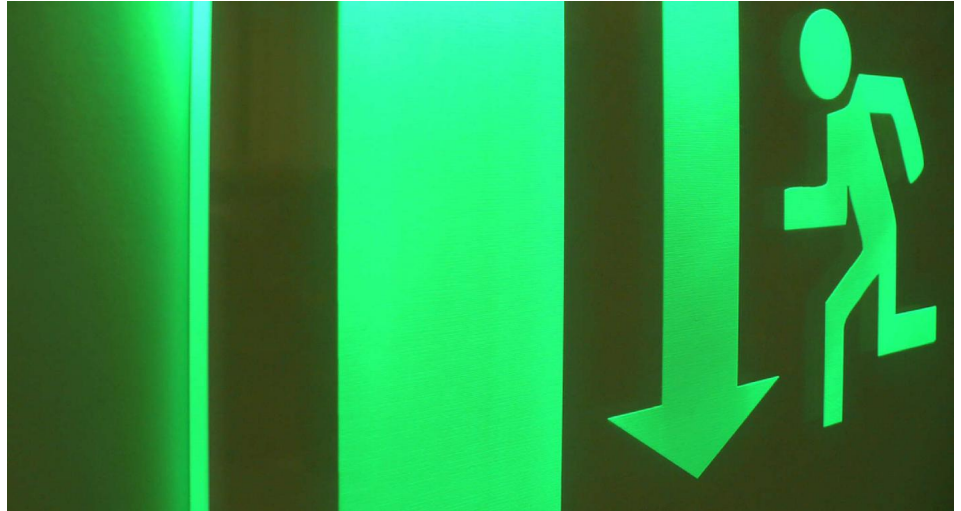

EXIT 09012 SURF

2.5W Surfaced Wall/Ceiling
Quicklink: Q49DA

General

Colour Green,White
Construction Plastic / Aluminium
IP Rating IP20

Battery 3 hours duration
Emergency Type Maintained and Non Maintained

Dimensions

Height 230mm
Length 310mm
Width 35mm

Electrical

Maximum Wattage 2.5W

Light Characteristics

Colour Temperature 6500K Daylight

The **LED Emergency Exit Blade** is an adjustable surface mounted LED exit light with an arrow up legend as standard. The pivot fitting can be ceiling or wall mounted for use above doors or in hallways. Sleek, low profile design. Suitable for commercial and industrial installations. Viewable from both sides. 25m viewing distance.

Features a manual push test indicator. Once activated, unit illuminates for 5 minutes to indicate fitting is functioning correctly. Key Test feature can also be used.

Emergency Exit Lights

LED Emergency Exit Blade
2.5W Surfaced Wall/Ceiling

